

22nd ANNUAL CARD FORUM & EXPO

MAY 16 - 18, 2010

HYATT REGENCY GRAND CYPRESS
ORLANDO, FLORIDA

REVISION DATE:
2/17/2010 GH

BOOTH COUNT

Inventory as of 02/17/2010

Dimension	Size	Qty	SqFt
10'x16'	160	1	160
16'x20'	320	1	320
8'x10'	80	36	2,880
8'x20'	160	7	1,120
Totals:			45 4,480

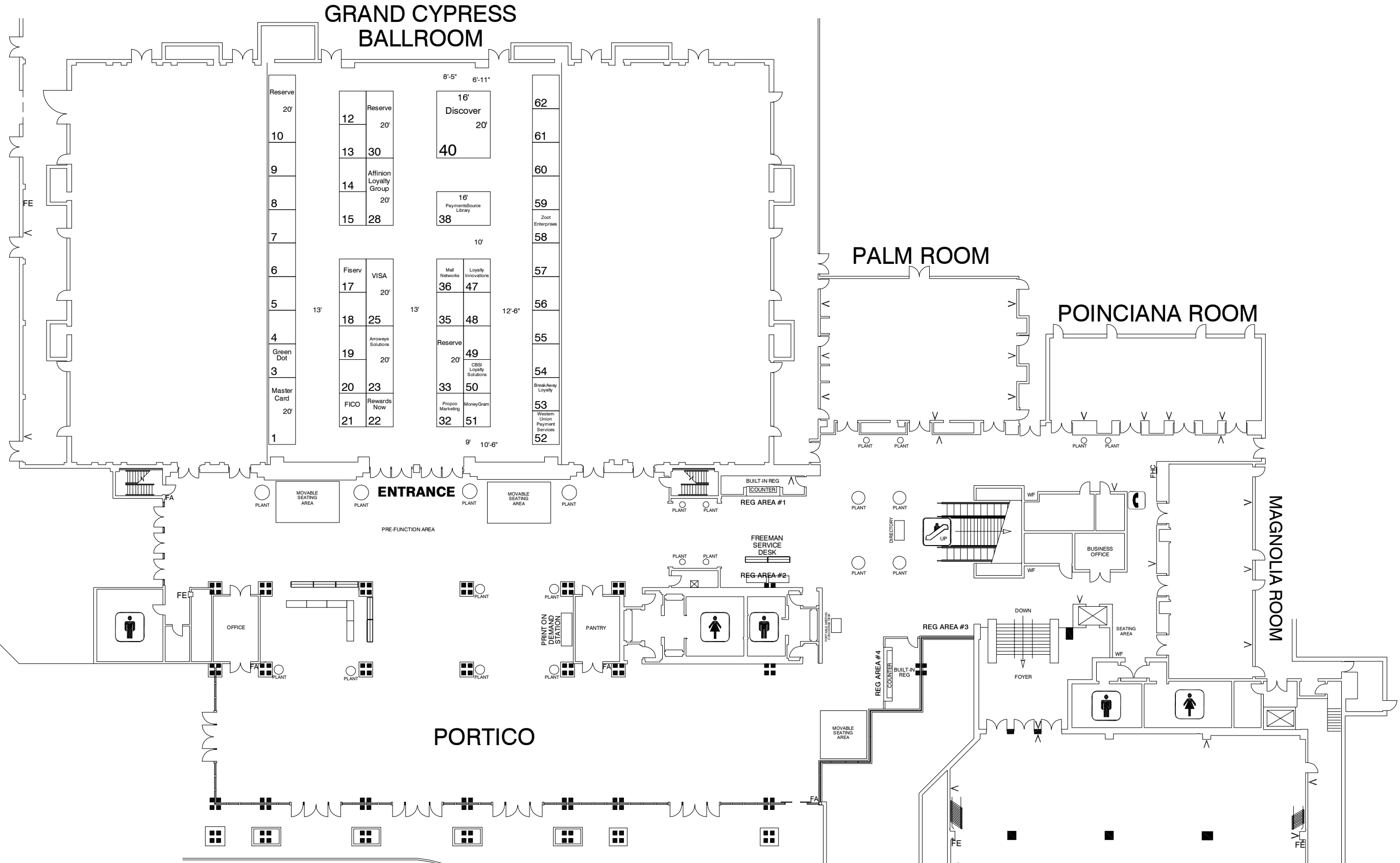

BLDG. LEGEND:

- FA = FIRE ALARM
- FX = FIRE EXTINGUISHER
- FHC = FIRE HOSE CABINET
- V = FIRE STROBES
- GRAND CYPRESS BALLROOM:
LOCATED ONLY ON THE CEILING

FREEMAN

DRAWING STARTED:
1/14/2010 TM E
FILE PATH:
O:\Design\Plans\SHOWS\10\05
May/Card Forum &
Expo\CFE510.dwg

DRAWING NAME:
CFE510
HALL NAME:
GRAND CYPRESS D-F
JOB NUMBER:
250278

ACCT. EXEC.
ALISON MADRID
NOT TO SCALE

DISCLAIMER

EVERY EFFORT HAS BEEN MADE TO ENSURE THE ACCURACY OF ALL INFORMATION CONTAINED ON THIS FLOORPLAN. HOWEVER NO WARRANTIES, EITHER EXPRESSED OR IMPLIED ARE MADE WITH RESPECT TO THIS FLOORPLAN. IF THE LOCATION OF BUILDING COLUMNS, UTILITIES OR OTHER ARCHITECTURAL COMPONENTS OF THE FACILITY IS A CONSIDERATION IN THE CONSTRUCTION OR USAGE OF AN EXHIBIT, IT IS THE SOLE RESPONSIBILITY OF THE EXHIBITOR TO PHYSICALLY INSPECT THE FACILITY TO VERIFY ALL DIMENSIONS AND LOCATIONS.
©COPYRIGHT 2007, FREEMAN CO.
ALL RIGHTS RESERVED.

22nd ANNUAL CARD FORUM & EXPO

MAY 16 - 18, 2010
 HYATT REGENCY GRAND CYPRESS
 ORLANDO, FLORIDA

GRAND CYPRESS BALLROOM

